

# Customer Care Solutions

## NHL-4J Series Transceivers

# Parts List

[This page left intentionally blank]

## Table of Contents

	<b>Page No</b>
Exploded View of Nokia 7250, NHL-4 .....	4
Mechanical Parts .....	5
Variant Parts .....	5
TB3 Module Parts, EDMS v. 5.2 .....	6

## Exploded View of Nokia 7250, NHL-4J

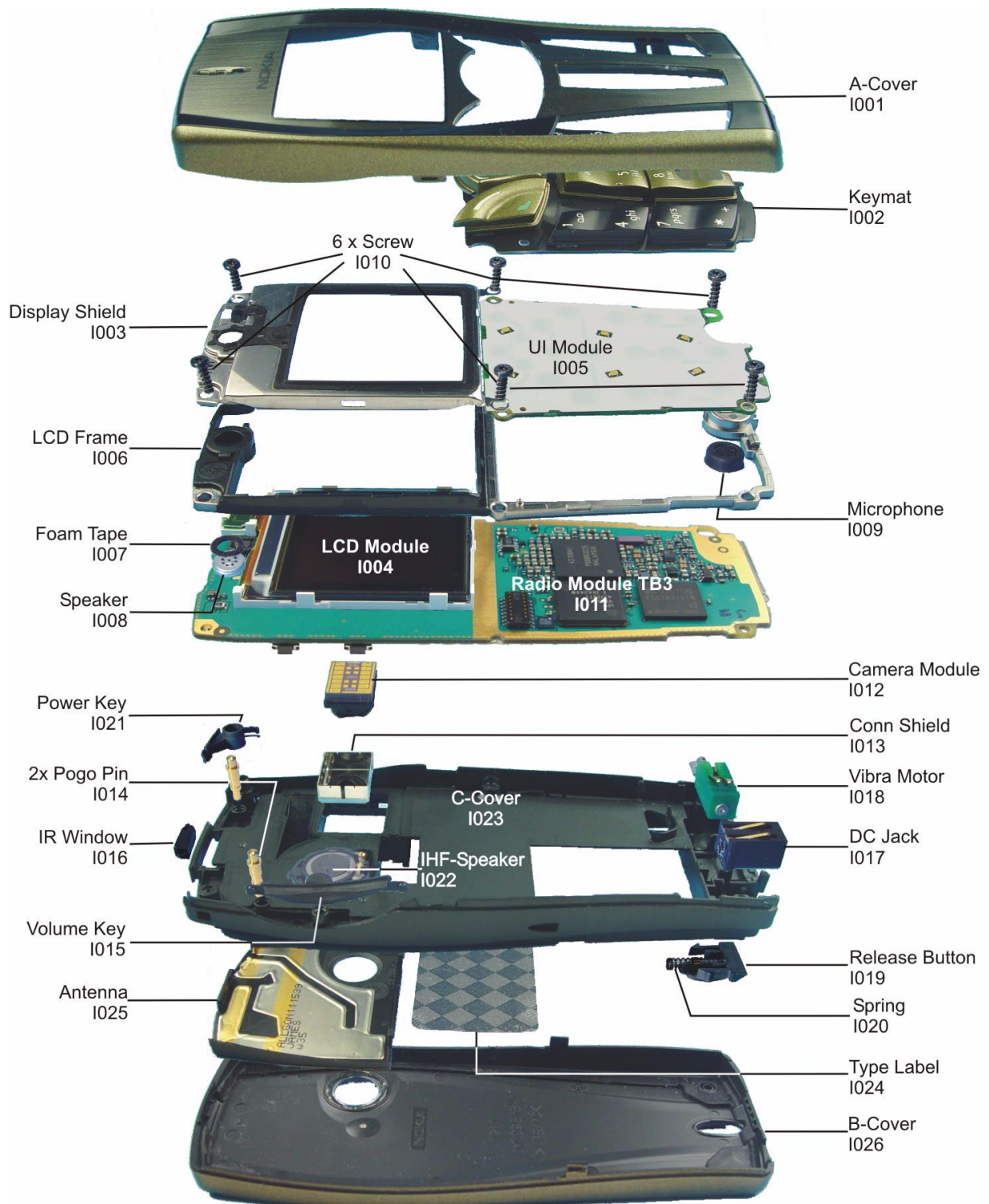

For the parts list refer to the next page.

**Mechanical Parts**

Table 1: NHL-4J Mechanical Parts

ITEM/ CIRCUIT REF.	QTY	PART NO	PART NAME
I003	1	9517173	DISPLAY SHIELD DMC04171 NHL-4
I004	1	4850291	LCD MOD/JAMES 130X130 COG COLOUR
I005	1	0201920	TK8 UI MODULE
I006	1	9467076	LCD FRAME DMC03935 NHL-4
I007	1	9470283	SPEAKER FOAM TAPE
I008	1	5140251	SPEAKER105+-3DB32R D8.1X2.25 PICO
I009	1	5140263	MIC+BOOT ASSY -42+-3DB D7.7X3MM
I010	6	6290107	SCREW 1.8X7.0 FE T6+ DMD05791 BLK
I011	1	XXXXXXX	TB3 RADIO MODULE
I012	1	4858003	CIF CAMERA MODULE, CCP/CCI
I013	1	9481013	CONN SHIELD CIF-J CLE9014-01E
I014	2	5400263	ANTENNA POGO PIN L=8.7MM D=2.1MM
I015	1	9790825	VOLUME KEY DMD07492 NHL-4J
I016	1	9452235	IR WINDOW DMD07490 NHL-4
I017	1	5400243	CONN DC-JACK 3.5MM 3POL SPR 90DEG
I018	1	6800057	VIB.MOTOR ASSY 1.3 VDC 11000 RPM
I019	1	9790826	RELEASE BUTTON DMD07493 NHL-4J
I020	1	9510845	SPRING NHL-4
I021	1	9790821	POWER KEY DMD07491 NHL-4J
I022	1	xxxxxxx	SPEAKER HF 69+-2DB8R D16X4.36
I023		9491355	C-COVER NHL-4J Assy for AMS
I024		9381257	TYPE LABEL, note code is for label roll
I025	1	0660281	ANTENNA INT ANTENNA EGSM/PCN/PCS

**Variant Parts**

Table 2: NHL-4J Variant Parts

ITEM/ CIRCUIT REF.	QTY	PART NO	PART NAME
I001	1	9491028	A-COVER ASSY PURPLE
I001	1	9491025	A-COVER ASSY BLUE
I001	1	9491026	A-COVER ASSY GREY
I002	1	9790828	KEYMAT LATIN PLUM
I002	1	9790827	KEYMAT LATIN BLUE
I002	1	9790832	KEYMAT LATIN GREY
I026	1	9491034	B-COVER ASSY PURPLE
I026	1	9491030	B-COVER ASSY BLUE
I026	1	9491029	B-COVER ASSY GREY

**TB3 Module Parts, EDMS v. 5.2**

Item	Code	Side	X	Y	Type	Name	Value
A356	9517242	Bottom	O	6	SHIELD_DMC05342	NECTAR J SHIELD AS DMC05342 NHL4J	~ ~
A500	9517241	Bottom	K	3	SHIELD_DMC05180	HELGA J SHIELD AS DMC05180 NHL-4J	~ ~
A700	9517259	Bottom	D	5	SHIELD_DMC05181	SHIELD ASSY PA DMC05075	~ ~
A970	9517244	Bottom	I	7	SHIELD_DMC05410	C J SHIELD ASSY DMC05410 NHL-4J	~ ~
B200	4510219	Top	P	7	CRYSTAL_CX_4V	CRYSTAL 32.768KHZ+-30PPM 9PF	32.768kHz ~
C100	2315201	Bottom	H	2	0405_2_P0.65	CHIP ARRAY NP0 2X27P K 25V 0405	2x27p 25V
C101	2320481	Top	R	5	0603C	CHIPCAP X5R 1U K 6V3 0603	1u0 6.3V
C102	2320481	Top	S	4	0603C	CHIPCAP X5R 1U K 6V3 0603	1u0 6.3V
C103	2321013	Top	P	6	0402C	CHIPCAP NP0 270P J 25V 0402	270p 25V
C104	2315201	Top	S	5	0405_2_P0.65	CHIP ARRAY NP0 2X27P K 25V 0405	2x27p 25V
C106	2320744	Top	Q	5	0402C	Chipcap X7R 10% 50V 0402	1n0 50V
C107	2320536	Top	S	7	0402C	Chipcap 5% NP0	10p 50V
C108	2320536	Top	S	7	0402C	Chipcap 5% NP0	10p 50V
C109	2320536	Top	R	7	0402C	Chipcap 5% NP0	10p 50V
C110	2320544	Top	R	5	0402C	Chipcap 5% NP0	22p 50V
C112	2320778	Top	S	4	0402C	Chipcap X7R 10% 16V 0402	10n 16V
C113	2320778	Top	R	6	0402C	Chipcap X7R 10% 16V 0402	10n 16V
C114	2320778	Top	S	6	0402C	Chipcap X7R 10% 16V 0402	10n 16V
C115	2320756	Top	Q	7	0402C	Chipcap X7R 10% 50V 0402	3n3 50V
C116	2320756	Top	R	7	0402C	Chipcap X7R 10% 50V 0402	3n3 50V
C117	2320536	Top	R	7	0402C	Chipcap 5% NP0	10p 50V
C118	2320778	Top	R	7	0402C	Chipcap X7R 10% 16V 0402	10n 16V
C119	2320778	Top	R	6	0402C	Chipcap X7R 10% 16V 0402	10n 16V
C150	2316001	Top	Q	6	0603C	CHIPCAP X5R 2U2 K 6V3 0603	2u2 6V3
C151	2315205	Top	R	5	0405_2_P0.65_AVX	CHIP ARRAY X5R 2X1N M 16V 0405	2x1n 16V
C152	2320805	Top	S	5	0402C	CHIPCAP X5R 100N K 10V 0402	100n 10V
C153	2315209	Top	R	5	0405_2_P0.65_AVX	CHIP ARRAY X5R 2X33N M 10V 0405	2x33n 10V
C154	2315209	Top	Q	6	0405_2_P0.65_AVX	CHIP ARRAY X5R 2X33N M 10V 0405	2x33n 10V
C155	2315201	Top	P	6	0405_2_P0.65	CHIP ARRAY NP0 2X27P K 25V 0405	2x27p 25V
C156	2315205	Top	Q	6	0405_2_P0.65_AVX	CHIP ARRAY X5R 2X1N M 16V 0405	2x1n 16V
C157	2315201	Top	S	6	0405_2_P0.65	CHIP ARRAY NP0 2X27P K 25V 0405	2x27p 25V
C158	2315201	Top	R	6	0405_2_P0.65	CHIP ARRAY NP0 2X27P K 25V 0405	2x27p 25V
C159	2315201	Top	Q	7	0405_2_P0.65	CHIP ARRAY NP0 2X27P K 25V 0405	2x27p 25V
C160	2320805	Top	Q	6	0402C	CHIPCAP X5R 100N K 10V 0402	100n 10V
C161	2320805	Top	Q	6	0402C	CHIPCAP X5R 100N K 10V 0402	100n 10V
C162	2320805	Bottom	P	6	0402C	CHIPCAP X5R 100N K 10V 0402	100n 10V
C163	2320805	Bottom	M	6	0402C	CHIPCAP X5R 100N K 10V 0402	100n 10V
C164	2315205	Bottom	F	5	0405_2_P0.65_AVX	CHIP ARRAY X5R 2X1N M 16V 0405	2x1n 16V
C165	2320805	Bottom	P	6	0402C	CHIPCAP X5R 100N K 10V 0402	100n 10V
C166	2320481	Top	R	6	0603C	CHIPCAP X5R 1U K 6V3 0603	1u0 6.3V
C167	2320481	Top	Q	5	0603C	CHIPCAP X5R 1U K 6V3 0603	1u0 6.3V
C168	2320805	Bottom	P	6	0402C	CHIPCAP X5R 100N K 10V 0402	100n 10V
C169	2320805	Top	Q	5	0402C	CHIPCAP X5R 100N K 10V 0402	100n 10V
C200	2320805	Top	N	7	0402C	CHIPCAP X5R 100N K 10V 0402	100n 10V
C201	2320481	Top	M	7	0603C	CHIPCAP X5R 1U K 6V3 0603	1u0 6.3V
C202	2320778	Top	M	7	0402C	Chipcap X7R 10% 16V 0402	10n 16V
C203	2320481	Top	P	4	0603C	CHIPCAP X5R 1U K 6V3 0603	1u0 6.3V
C204	2320481	Bottom	M	7	0603C	CHIPCAP X5R 1U K 6V3 0603	1u0 6.3V
C205	2320481	Top	O	7	0603C	CHIPCAP X5R 1U K 6V3 0603	1u0 6.3V
C206	2320481	Top	O	7	0603C	CHIPCAP X5R 1U K 6V3 0603	1u0 6.3V
C207	2320481	Top	P	4	0603C	CHIPCAP X5R 1U K 6V3 0603	1u0 6.3V
C208	2320481	Top	N	7	0603C	CHIPCAP X5R 1U K 6V3 0603	1u0 6.3V
C209	2320536	Top	P	7	0402C	Chipcap 5% NP0	10p 50V
C210	2320536	Top	Q	7	0402C	Chipcap 5% NP0	10p 50V
C211	2320481	Top	O	7	0603C	CHIPCAP X5R 1U K 6V3 0603	1u0 6.3V
C212	2320481	Top	P	7	0603C	CHIPCAP X5R 1U K 6V3 0603	1u0 6.3V
C213	2320481	Top	O	7	0603C	CHIPCAP X5R 1U K 6V3 0603	1u0 6.3V
C214	2320481	Top	P	6	0603C	CHIPCAP X5R 1U K 6V3 0603	1u0 6.3V
C215	2320481	Top	P	6	0603C	CHIPCAP X5R 1U K 6V3 0603	1u0 6.3V
C218	2320805	Top	P	5	0402C	CHIPCAP X5R 100N K 10V 0402	100n 10V
C219	2320481	Top	N	7	0603C	CHIPCAP X5R 1U K 6V3 0603	1u0 6.3V
C220	2320778	Top	Q	5	0402C	Chipcap X7R 10% 16V 0402	10n 16V
C221	2320481	Top	M	7	0603C	CHIPCAP X5R 1U K 6V3 0603	1u0 6.3V
C222	2320481	Top	M	6	0603C	CHIPCAP X5R 1U K 6V3 0603	1u0 6.3V

Item	Code	Side	X	Y	Type	Name	Value
C223	2320481	Top	L	6	0603C	CHIPCAP X5R 1U K 6V3 0603	1u0 6.3V
C224	2320481	Top	L	5	0603C	CHIPCAP X5R 1U K 6V3 0603	1u0 6.3V
C225	2320481	Top	M	6	0603C	CHIPCAP X5R 1U K 6V3 0603	1u0 6.3V
C226	2320481	Top	M	5	0603C	CHIPCAP X5R 1U K 6V3 0603	1u0 6.3V
C227	2320481	Top	L	5	0603C	CHIPCAP X5R 1U K 6V3 0603	1u0 6.3V
C228	2320481	Top	M	5	0603C	CHIPCAP X5R 1U K 6V3 0603	1u0 6.3V
C229	2320481	Top	L	5	0603C	CHIPCAP X5R 1U K 6V3 0603	1u0 6.3V
C230	2320481	Top	L	5	0603C	CHIPCAP X5R 1U K 6V3 0603	1u0 6.3V
C231	2320481	Top	M	5	0603C	CHIPCAP X5R 1U K 6V3 0603	1u0 6.3V
C232	2320481	Top	M	5	0603C	CHIPCAP X5R 1U K 6V3 0603	1u0 6.3V
C233	2320481	Top	M	6	0603C	CHIPCAP X5R 1U K 6V3 0603	1u0 6.3V
C234	2320481	Top	M	5	0603C	CHIPCAP X5R 1U K 6V3 0603	1u0 6.3V
C235	2320481	Top	P	7	0603C	CHIPCAP X5R 1U K 6V3 0603	1u0 6.3V
C236	2320805	Top	M	4	0402C	CHIPCAP X5R 100N K 10V 0402	100n 10V
C237	2320805	Top	M	4	0402C	CHIPCAP X5R 100N K 10V 0402	100n 10V
C238	2320805	Top	N	7	0402C	CHIPCAP X5R 100N K 10V 0402	100n 10V
C239	2320805	Top	Q	5	0402C	CHIPCAP X5R 100N K 10V 0402	100n 10V
C240	2320778	Top	Q	5	0402C	Chipcap X7R 10% 16V 0402	10n 16V
C241	2320744	Top	Q	5	0402C	Chipcap X7R 10% 50V 0402	1n0 50V
C242	2320744	Top	Q	5	0402C	Chipcap X7R 10% 50V 0402	1n0 50V
C243	2320481	Top	Q	5	0603C	CHIPCAP X5R 1U K 6V3 0603	1u0 6.3V
C260	2320481	Top	M	6	0603C	CHIPCAP X5R 1U K 6V3 0603	1u0 6.3V
C261	2320481	Top	O	7	0603C	CHIPCAP X5R 1U K 6V3 0603	1u0 6.3V
C262	2320481	Top	M	6	0603C	CHIPCAP X5R 1U K 6V3 0603	1u0 6.3V
C263	2320481	Top	M	6	0603C	CHIPCAP X5R 1U K 6V3 0603	1u0 6.3V
C264	2320481	Top	N	7	0603C	CHIPCAP X5R 1U K 6V3 0603	1u0 6.3V
C265	2320481	Top	Q	5	0603C	CHIPCAP X5R 1U K 6V3 0603	1u0 6.3V
C302	2320556	Top	K	6	0402C	Chipcap 5% NP0	68p 50V
C303	2320125	Top	L	7	0603C	CHIPCAP X5R 1U K 16V 0603	1u0 16V
C304	2320125	Top	L	7	0603C	CHIPCAP X5R 1U K 16V 0603	1u0 16V
C306	2320778	Bottom	R	5	0402C	Chipcap X7R 10% 16V 0402	10n 16V
C310	2320544	Bottom	A	5	0402C	Chipcap 5% NP0	22p 50V
C350	2312243	Bottom	B	4	0805C	CHIPCAP X5R 4U7 K 6V3 0805	4u7 6V3
C352	2320805	Bottom	A	4	0402C	CHIPCAP X5R 100N K 10V 0402	100n 10V
C353	2320805	Bottom	B	3	0402C	CHIPCAP X5R 100N K 10V 0402	100n 10V
C357	2320778	Bottom	O	7	0402C	Chipcap X7R 10% 16V 0402	10n 16V
C358	2320785	Bottom	O	7	0402C	chipcap x7r 47n k 10v 0402	47n 10V
C359	2320805	Bottom	O	6	0402C	CHIPCAP X5R 100N K 10V 0402	100n 10V
C361	2320744	Bottom	M	6	0402C	Chipcap X7R 10% 50V 0402	1n0 50V
C362	2320778	Bottom	O	6	0402C	Chipcap X7R 10% 16V 0402	10n 16V
C363	2315261	Bottom	M	7	0405_2_P0.65	CHIP ARRAY X5R 2X47N K 10V 0405	2x47n 10V
C364	2321007	Bottom	N	5	0402C	CERCAP X7R 22N K 16V 0402	22n 16V
C365	2315209	Bottom	M	6	0405_2_P0.65_AVX	CHIP ARRAY X5R 2X33N M 10V 0405	2x33n 10V
C366	2320785	Bottom	M	7	0402C	chipcap x7r 47n k 10v 0402	47n 10V
C367	2320560	Bottom	O	8	0402C	Chipcap 5% NP0	100p 50V
C370	2320760	Bottom	O	7	0402C	Chipcap X7R 10% 25V 0402	4n7 25V
C371	2320778	Bottom	M	7	0402C	Chipcap X7R 10% 16V 0402	10n 16V
C372	2320481	Bottom	N	7	0603C	CHIPCAP X5R 1U K 6V3 0603	1u0 6.3V
C373	2321007	Bottom	M	5	0402C	CERCAP X7R 22N K 16V 0402	22n 16V
C374	2320744	Bottom	N	6	0402C	Chipcap X7R 10% 50V 0402	1n0 50V
C375	2320752	Bottom	N	5	0402C	Chipcap X7R 10% 50V 0402	2n2 50V
C378	2320546	Bottom	N	7	0402C	Chipcap 5% NP0	27p 50V
C379	2320552	Bottom	N	7	0402C	Chipcap 5% NP0	47p 50V
C390	2320805	Bottom	S	2	0402C	CHIPCAP X5R 100N K 10V 0402	100n 10V
C400	2320778	Top	P	3	0402C	Chipcap X7R 10% 16V 0402	10n 16V
C401	2320805	Top	P	4	0402C	CHIPCAP X5R 100N K 10V 0402	100n 10V
C402	2320778	Top	M	4	0402C	Chipcap X7R 10% 16V 0402	10n 16V
C403	2320778	Top	M	2	0402C	Chipcap X7R 10% 16V 0402	10n 16V
C404	2320778	Top	P	3	0402C	Chipcap X7R 10% 16V 0402	10n 16V
C405	2320778	Top	M	3	0402C	Chipcap X7R 10% 16V 0402	10n 16V
C420	2320560	Top	M	3	0402C	Chipcap 5% NP0	100p 50V
C421	2320560	Top	M	4	0402C	Chipcap 5% NP0	100p 50V
C422	2320560	Top	M	4	0402C	Chipcap 5% NP0	100p 50V
C450	2320778	Top	S	3	0402C	Chipcap X7R 10% 16V 0402	10n 16V
C451	2320805	Top	P	3	0402C	CHIPCAP X5R 100N K 10V 0402	100n 10V

Item	Code	Side	X	Y	Type	Name	Value	
C454	2320779	Top	Q	4	0603_BLM	CHIPCAP X7R 100N K 16V 0603	100n	16V
C501	2320536	Bottom	K	2	0402C	Chipcap 5% NP0	10p	50V
C503	2320564	Bottom	K	2	0402C	Chipcap 5% NP0	150p	50V
C504	2322015	Bottom	K	2	0603C	CHIPCAP NP0 2N2 G 16V 0603	2n2	16V
C505	2321013	Bottom	K	5	0402C	CHIPCAP NP0 270P J 25V 0402	270p	25V
C507	2322023	Bottom	I	4	0603C	CHIPCAP NP0 2N2 J 16V 0603	2n2	16V
C511	2320560	Bottom	C	7	0402C	Chipcap 5% NP0	100p	50V
C520	2320554	Bottom	J	5	0402C	Chipcap 5% NP0	56p	50V
C522	2320604	Bottom	I	5	0402C	Chipcap 5% NP0	18p	50V
C523	2320598	Bottom	J	5	0402C	Chipcap 5% X7R	3n9	50V
C531	2320546	Bottom	F	5	0402C	Chipcap 5% NP0	27p	50V
C532	2320604	Bottom	I	4	0402C	Chipcap 5% NP0	18p	50V
C533	2320554	Bottom	I	4	0402C	Chipcap 5% NP0	56p	50V
C534	2320744	Bottom	K	5	0402C	Chipcap X7R 10% 50V 0402	1n0	50V
C535	2320552	Bottom	K	4	0402C	Chipcap 5% NP0	47p	50V
C536	2320552	Bottom	K	4	0402C	Chipcap 5% NP0	47p	50V
C537	2320560	Bottom	K	5	0402C	Chipcap 5% NP0	100p	50V
C540	2320491	Bottom	L	4	0603C	CHIPCAP X7R 220N K 10V 0603	220n	10V
C543	2320558	Bottom	L	3	0402C	Chipcap 5% NP0	82p	50V
C545	2315017	Bottom	J	2	0612_W3A4_CAF13	CHIP ARRAY NP0 4X470P J 16V 0612	4x470p	16V
C549	2320805	Bottom	J	3	0402C	CHIPCAP X5R 100N K 10V 0402	100n	10V
C550	2320570	Bottom	J	5	0402C	Chipcap 5% X7R	270p	50V
C551	2320546	Bottom	K	5	0402C	Chipcap 5% NP0	27p	50V
C552	2320805	Bottom	K	4	0402C	CHIPCAP X5R 100N K 10V 0402	100n	10V
C553	2320536	Bottom	K	4	0402C	Chipcap 5% NP0	10p	50V
C554	2320778	Bottom	L	4	0402C	Chipcap X7R 10% 16V 0402	10n	16V
C555	2320805	Bottom	J	2	0402C	CHIPCAP X5R 100N K 10V 0402	100n	10V
C560	2320744	Bottom	K	2	0402C	Chipcap X7R 10% 50V 0402	1n0	50V
C568	2320907	Bottom	J	5	0402C_AVX	CHIPCAP NP0 HQ 0P7 B 16V 0402	0p7	16V
C570	2320544	Bottom	I	2	0402C	Chipcap 5% NP0	22p	50V
C571	2320560	Bottom	I	5	0402C	Chipcap 5% NP0	100p	50V
C572	2320560	Bottom	J	2	0402C	Chipcap 5% NP0	100p	50V
C573	2320554	Bottom	I	4	0402C	Chipcap 5% NP0	56p	50V
C575	2320526	Bottom	J	3	0402C	Chipcap +-0.25pF NP0	3p9	50V
C703	2310045	Bottom	E	3	0402C_GRM36	CHIPCAP X5R 68N K 10V 0402	68n	10V
C704	2310045	Bottom	D	2	0402C_GRM36	CHIPCAP X5R 68N K 10V 0402	68n	10V
C705	2320546	Bottom	D	2	0402C	Chipcap 5% NP0	27p	50V
C706	2320546	Bottom	D	2	0402C	Chipcap 5% NP0	27p	50V
C707	2320518	Bottom	F	3	0402C	Chipcap +-0.25pF NP0	1p8	50V
C708	2320508	Bottom	I	4	0402C	Chipcap +-0.25pF NP0	1p0	50V
C709	2320540	Bottom	C	2	0402C	Chipcap 5% NP0	15p	50V
C710	2320540	Bottom	C	3	0402C	Chipcap 5% NP0	15p	50V
C711	2320522	Bottom	C	3	0402C	Chipcap +-0.25pF NP0	2p7	50V
C713	2320584	Bottom	E	3	0402C	Chipcap 5% X7R	1n0	50V
C714	2320584	Bottom	C	3	0402C	Chipcap 5% X7R	1n0	50V
C715	2320554	Bottom	F	4	0402C	Chipcap 5% NP0	56p	50V
C718	2320584	Bottom	F	5	0402C	Chipcap 5% X7R	1n0	50V
C719	2320584	Bottom	D	3	0402C	Chipcap 5% X7R	1n0	50V
C723	2320540	Bottom	C	5	0402C	Chipcap 5% NP0	15p	50V
C724	2320778	Bottom	D	5	0402C	Chipcap X7R 10% 16V 0402	10n	16V
C725	2312243	Bottom	C	5	0805C	CHIPCAP X5R 4U7 K 6V3 0805	4u7	6V3
C726	2320546	Bottom	B	5	0402C	Chipcap 5% NP0	27p	50V
C727	2611745	Bottom	L	7	TANT_TPSY	CHIPTCAP 150U M 10V 7.3X4.3X2.0	150u_10V	10V
C728	2320560	Bottom	D	3	0402C	Chipcap 5% NP0	100p	50V
C729	2320554	Bottom	D	5	0402C	Chipcap 5% NP0	56p	50V
C730	2320546	Bottom	G	5	0402C	Chipcap 5% NP0	27p	50V
C804	2320560	Bottom	D	6	0402C	Chipcap 5% NP0	100p	50V
C805	2320560	Bottom	C	7	0402C	Chipcap 5% NP0	100p	50V
C806	2320544	Bottom	C	6	0402C	Chipcap 5% NP0	22p	50V
C807	2320560	Bottom	I	3	0402C	Chipcap 5% NP0	100p	50V
C808	2320560	Bottom	I	3	0402C	Chipcap 5% NP0	100p	50V
C826	2320560	Bottom	B	7	0402C	Chipcap 5% NP0	100p	50V
C827	2320805	Bottom	C	8	0402C	CHIPCAP X5R 100N K 10V 0402	100n	10V
C828	2320540	Bottom	C	8	0402C	Chipcap 5% NP0	15p	50V
C829	2320516	Bottom	C	8	0402C	Chipcap +-0.25pF NP0	1p5	50V



Item	Code	Side	X	Y	Type	Name	Value
C830	2320508	Bottom	I	2	0402C	Chipcap +-0.25pF NP0	1p0 50V
C831	2320552	Bottom	D	6	0402C	Chipcap 5% NP0	47p 50V
C836	2320524	Bottom	I	3	0402C	Chipcap +-0.25pF NP0	3p3 50V
C837	2320524	Bottom	I	3	0402C	Chipcap +-0.25pF NP0	3p3 50V
C838	2320540	Bottom	I	3	0402C	Chipcap 5% NP0	15p 50V
C839	2320540	Bottom	I	3	0402C	Chipcap 5% NP0	15p 50V
C970	2320805	Bottom	G	7	0402C	CHIPCAP X5R 100N K 10V 0402	100n 10V
C971	2320546	Bottom	G	7	0402C	Chipcap 5% NP0	27p 50V
C972	2320778	Bottom	J	6	0402C	Chipcap X7R 10% 16V 0402	10n 16V
C973	2320481	Bottom	G	6	0603C	CHIPCAP X5R 1U K 6V3 0603	1u0 6.3V
C974	2320546	Bottom	G	6	0402C	Chipcap 5% NP0	27p 50V
C975	2320778	Bottom	I	7	0402C	Chipcap X7R 10% 16V 0402	10n 16V
C976	2320778	Bottom	J	7	0402C	Chipcap X7R 10% 16V 0402	10n 16V
C977	2320778	Bottom	I	7	0402C	Chipcap X7R 10% 16V 0402	10n 16V
C978	2320805	Bottom	I	6	0402C	CHIPCAP X5R 100N K 10V 0402	100n 10V
C979	2320778	Bottom	I	6	0402C	Chipcap X7R 10% 16V 0402	10n 16V
C980	2320778	Bottom	J	7	0402C	Chipcap X7R 10% 16V 0402	10n 16V
C981	2320778	Bottom	I	7	0402C	Chipcap X7R 10% 16V 0402	10n 16V
C982	2320481	Bottom	H	7	0603C	CHIPCAP X5R 1U K 6V3 0603	1u0 6.3V
C983	2316001	Bottom	H	6	0603C	CHIPCAP X5R 2U2 K 6V3 0603	2u2 6V3
C984	2316001	Bottom	H	6	0603C	CHIPCAP X5R 2U2 K 6V3 0603	2u2 6V3
D200	4370825	Top	O	5	uBGA168	UEMK 4 4 W-DOG ENA TO21 TFBGA168	~ ~
D400	4370873	Top	N	3	uBGA144_CC	UPP8M V2.2 F751986B C035 UBGA144	~ ~
D450	4341445	Top	Q	3	COMBO_128MB_SI	COMBO NMP DCT4 128M NOR + 8M SRAM	8MX16/51;~
D970	4370955	Bottom	J	7	uBGA_56	HW ACCELERATOR STV0900V3_1 6X6BGA	~ ~
F100	5119019	Bottom	S	3	0603_FUSE	SM FUSE F 1.5A 32V 0603	1.5A ~
G300	4700131	Bottom	Q	6	XH414_1I02N	CELL CAPACITOR 0.01MAH 3V3	3V3 ~
G500	4350315	Bottom	L	2	VCO_FDK_IT_H1.7	VCO 3420-3980MHZ 2.7V 19MA	3420-3980 ~
G501	4510391	Bottom	L	5	TCO_9141	VCTCXO 26MHZ+-10PPM 2.7V 1.7MA	26MHz ~
L100	3203743	Top	R	4	0805_BLM21	FERR.BEAD 0R03 42R/100MHZ 3A 0805	42R/100M;~
L101	3203725	Top	S	5	FERRITE_0402	FERRITE BEAD 0R6 600R/100M 0402	600R/100M ~
L102	3203803	Top	R	7	0405_2_H1.0	CHIP BEAD ARRAY 2X1000R 0405	2x1000R/1 ~
L103	3203803	Top	S	6	0405_2_H1.0	CHIP BEAD ARRAY 2X1000R 0405	2x1000R/1 ~
L104	3203803	Top	R	7	0405_2_H1.0	CHIP BEAD ARRAY 2X1000R 0405	2x1000R/1 ~
L105	3645011	Top	S	7	COIL_LK_1608	CHIP COIL 68NH J Q12/100MHZ 0603	68nH ~
L106	3203725	Top	T	4	FERRITE_0402	FERRITE BEAD 0R6 600R/100M 0402	600R/100M ~
L107	3203741	Top	T	4	0603_BLM	FERRITE BEAD 0R5 600R/100MHZ 0603	600R/100M ~
L150	3203803	Top	A	3	0405_2_H1.0	CHIP BEAD ARRAY 2X1000R 0405	2x1000R/1 ~
L151	3645349	Bottom	F	5	COIL_0603CS	CHIP COIL 33NH G Q40/250MHZ 0603	33nH ~
L152	3645349	Bottom	F	4	COIL_0603CS	CHIP COIL 33NH G Q40/250MHZ 0603	33nH ~
L260	3203741	Top	M	6	0603_BLM	FERRITE BEAD 0R5 600R/100MHZ 0603	600R/100M ~
L261	3203741	Top	O	7	0603_BLM	FERRITE BEAD 0R5 600R/100MHZ 0603	600R/100M ~
L262	3203741	Top	M	6	0603_BLM	FERRITE BEAD 0R5 600R/100MHZ 0603	600R/100M ~
L263	3203741	Top	M	6	0603_BLM	FERRITE BEAD 0R5 600R/100MHZ 0603	600R/100M ~
L264	3203741	Top	M	7	0603_BLM	FERRITE BEAD 0R5 600R/100MHZ 0603	600R/100M ~
L265	3203741	Top	Q	5	0603_BLM	FERRITE BEAD 0R5 600R/100MHZ 0603	600R/100M ~
L300	3640119	Bottom	L	6	CHOKE_984FB	CHOKE 22U M 1R4 0.33A 3.3X3.3X1.5	22uH ~
L356	3645349	Bottom	O	7	COIL_0603CS	CHIP COIL 33NH G Q40/250MHZ 0603	33nH ~
L357	3645349	Bottom	O	7	COIL_0603CS	CHIP COIL 33NH G Q40/250MHZ 0603	33nH ~
L358	3645233	Bottom	N	7	COIL_JELF243Q	CHIP COIL 120N G Q32/150MHZ 0603	120nH ~
L500	3646053	Bottom	J	5	0402L	CHIP COIL 4N7 +-0N3 Q28/800M 0402	4n7H ~
L501	3646053	Bottom	J	5	0402L	CHIP COIL 4N7 +-0N3 Q28/800M 0402	4n7H ~
L502	3203725	Bottom	K	5	FERRITE_0402	FERRITE BEAD 0R6 600R/100M 0402	600R/100M ~
L700	3646069	Bottom	E	2	0402L	CHIP COIL 33N J Q23/800M 0402	33nH ~
L701	3646063	Bottom	F	2	0402L	CHIP COIL 22N J Q28/800M 0402	22nH ~
L702	3646053	Bottom	B	3	0402L	CHIP COIL 4N7 +-0N3 Q28/800M 0402	4n7H ~
L703	3203743	Bottom	C	5	0805_BLM21	FERR.BEAD 0R03 42R/100MHZ 3A 0805	42R/100M;~
L800	3646051	Bottom	C	7	0402L	CHIP COIL 3N9 +-0N3 Q28/800M 0402	3n9H ~
L805	3646055	Bottom	I	3	0402L	CHIP COIL 8N2 J Q28/800MHZ 0402	8n2H ~
L809	3646067	Bottom	I	3	0402L	CHIP COIL 18N J Q29/800M 0402	18nH ~
L810	3646067	Bottom	I	3	0402L	CHIP COIL 18N J Q29/800M 0402	18nH ~
L821	3646091	Bottom	I	3	0402L	CHIP COIL 6N8 J Q27/800M 0402	6n8H ~
N100	4341063	Top	S	4	SOT23_5_H1.2	REG 2.8V/150MA LP3985 SOT23-5	~ 2.8V
N150	4341417	Top	R	6	USMD18	AF AMP 85MW 5V LM4851TLX USMD18	~ ~
N300	4341309	Top	L	6	SOT23L_8	DC/DC CONV 350MA TK11851 SSOP8	~ ~

Item	Code	Side	X	Y	Type	Name	Value	
N350	4860181	Bottom	A	2	IRDA_CIM_50M5_T2	IRDA CIM-50M5 1.152MB >2.4V 8PIN	~	~
N356	4341427	Bottom	N	6	HVQFN40	FM RECEIVER TEA5767HN LQFP40	~	~
N500	4370895	Bottom	J	4	uBGA_108_P0.5	HLGA618A TFA3F TFBGA108	~	~
N700	4350383	Bottom	D	4	PW_AMP_RF9219_E1	PWAMP RF9219E2.X 900/1800/1900MHZ	~	~
N970	4341485	Bottom	H	7	USMD5_1.137X0.96	REG 1.8V/150MA (LP2985IBLX) USMD5	~	1.8V
R100	1430726	Top	T	5	0402R	Resistor 5% 63mW	100R	~
R101	1430726	Top	S	5	0402R	Resistor 5% 63mW	100R	~
R102	1430726	Top	T	5	0402R	Resistor 5% 63mW	100R	~
R103	4120011	Top	T	5	uBGA5	ZDIX4 IP4043CX5 CA 14V2 10W CSP5	~	~
R104	1430812	Top	S	5	0402R	Resistor 5% 63mW	220k	~
R105	1825033	Top	S	6	0402_VAR	CHIP VARISTOR VW14V VC46V 0402	14V/46V	~
R106	1825033	Top	R	6	0402_VAR	CHIP VARISTOR VW14V VC46V 0402	14V/46V	~
R107	1825033	Top	R	6	0402_VAR	CHIP VARISTOR VW14V VC46V 0402	14V/46V	~
R108	1825033	Top	R	6	0402_VAR	CHIP VARISTOR VW14V VC46V 0402	14V/46V	~
R109	1430804	Top	P	5	0402R	Resistor 5% 63mW	100k	~
R111	1430804	Top	R	4	0402R	Resistor 5% 63mW	100k	~
R151	1825033	Top	A	3	0402_VAR	CHIP VARISTOR VW14V VC46V 0402	14V/46V	~
R152	1825033	Top	B	3	0402_VAR	CHIP VARISTOR VW14V VC46V 0402	14V/46V	~
R153	1430137	Top	Q	6	0402R	CHIPRES 0W06 1K0 F 200PPM 0402	1k0	~
R154	1430137	Top	Q	6	0402R	CHIPRES 0W06 1K0 F 200PPM 0402	1k0	~
R155	1620105	Top	Q	6	MNR02	RES NETWORK 0W06 2X2k2 J 0404	2x2k2	~
R156	1430762	Top	S	5	0402R	Resistor 5% 63mW	2k2	~
R157	1620105	Top	S	5	MNR02	RES NETWORK 0W06 2X2k2 J 0404	2x2k2	~
R158	1825033	Top	R	6	0402_VAR	CHIP VARISTOR VW14V VC46V 0402	14V/46V	~
R159	1825033	Top	Q	7	0402_VAR	CHIP VARISTOR VW14V VC46V 0402	14V/46V	~
R161	1825033	Bottom	G	5	0402_VAR	CHIP VARISTOR VW14V VC46V 0402	14V/46V	~
R162	1825033	Bottom	G	5	0402_VAR	CHIP VARISTOR VW14V VC46V 0402	14V/46V	~
R163	1430764	Top	Q	6	0402R	Resistor 5% 63mW	3k3	~
R164	1430700	Top	R	5	0402R	Resistor 5% 63mW	10R	~
R165	1430700	Top	R	6	0402R	Resistor 5% 63mW	10R	~
R166	1430700	Top	R	6	0402R	Resistor 5% 63mW	10R	~
R167	1430700	Top	R	6	0402R	Resistor 5% 63mW	10R	~
R200	1414605	Top	N	7	0805R_THERM1	CHIPRES 0W25 0R22 J 0805	0R22	~
R202	1620043	Top	P	5	EXB28V	RES NETWORK 0W03 4X100K J 0804	4x100k	~
R206	1430770	Top	P	5	0402R	Resistor 5% 63mW	4k7	~
R207	1430770	Top	P	5	0402R	Resistor 5% 63mW	4k7	~
R300	1430712	Top	K	7	0402R	Resistor 5% 63mW	27R	~
R301	1430734	Top	L	3	0402R	Resistor 5% 63mW	220R	~
R306	1430778	Bottom	A	5	0402R	Resistor 5% 63mW	10k	~
R307	1825033	Top	L	4	0402_VAR	CHIP VARISTOR VW14V VC46V 0402	14V/46V	~
R308	1430740	Bottom	B	6	0402R	Resistor 5% 63mW	330R	~
R309	1430740	Bottom	B	6	0402R	Resistor 5% 63mW	330R	~
R350	1413850	Top	B	2	0805R_THERM1	CHIPRES 0W125 4R7 J 0805	4R7	~
R357	1430792	Bottom	O	6	0402R	Resistor 5% 63mW	33k	~
R359	1430778	Bottom	O	7	0402R	Resistor 5% 63mW	10k	~
R360	1430804	Bottom	O	7	0402R	Resistor 5% 63mW	100k	~
R361	1620019	Bottom	O	6	0404_R_SR	RES NETWORK 0W06 2X10K J 0404	2x10k	~
R367	1430786	Bottom	M	7	0402R	Resistor 5% 63mW	18k	~
R369	1430792	Bottom	M	5	0402R	Resistor 5% 63mW	33k	~
R388	4120071	Top	Q	4	uBGA8	ASIP EMIF03-SIM01 SIM FILTER BGA8	~	~
R420	1430726	Top	M	3	0402R	Resistor 5% 63mW	100R	~
R421	1430778	Top	M	4	0402R	Resistor 5% 63mW	10k	~
R422	1430873	Top	L	4	0402R	CHIPRES 0W06 27K F 0402	27k	~
R423	1430778	Top	L	4	0402R	Resistor 5% 63mW	10k	~
R450	1430770	Top	Q	4	0402R	Resistor 5% 63mW	4k7	~
R500	1430693	Bottom	K	2	0402R	Chipres 0W06 5R6 J 0402	5R6	~
R501	1430754	Bottom	K	2	0402R	Resistor 5% 63mW	1k0	~
R502	1430337	Bottom	J	2	0603R	CHIPRES 0W06 9K1 F 0603	9k1	~
R503	1430770	Bottom	I	4	0402R	Resistor 5% 63mW	4k7	~
R504	1430788	Bottom	I	4	0402R	Resistor 5% 63mW	22k	~
R516	1620033	Bottom	L	4	0404_R	RES NETWORK 0W06 2X5K6 J 0404	2x5k6	~
R517	1620033	Bottom	L	4	0404_R	RES NETWORK 0W06 2X5K6 J 0404	2x5k6	~
R520	1430774	Bottom	L	4	0402R	Resistor 5% 63mW	6k8	~
R522	1430784	Bottom	L	3	0402R	Resistor 5% 63mW	15k	~
R523	1430772	Bottom	K	3	0402R	Resistor 5% 63mW	5k6	~

Item	Code	Side	X	Y	Type	Name	Value
R525	1430770	Bottom	K	3	0402R	Resistor 5% 63mW	4k7 ~
R540	1430754	Bottom	J	2	0402R	Resistor 5% 63mW	1k0 ~
R542	1620505	Bottom	L	3	0404_RAC10	RES NETWORK 0W04 2DB ATT 0404	436R/11R ~
R703	1430714	Bottom	E	3	0402R	Resistor 5% 63mW	33R ~
R704	1430714	Bottom	D	2	0402R	Resistor 5% 63mW	33R ~
R706	1430681	Bottom	F	2	0402R	CHIPRES 0W06 4R3 J 0402	4R3 ~
R709	1430756	Bottom	F	4	0402R	Resistor 5% 63mW	1k2 ~
R710	1430766	Bottom	F	4	0402R	Resistor 5% 63mW	3k9 ~
R714	1430690	Bottom	D	3	0402R	Chipres 0W06 jumper 0402	0R ~
R715	1430691	Bottom	E	3	0402R	CHIPRES 0W06 2R2 J 0402	2R2 ~
R750	1430690	Bottom	C	3	0402R	Chipres 0W06 jumper 0402	0R ~
R800	1430700	Bottom	C	8	0402R	Resistor 5% 63mW	10R ~
R801	1430726	Bottom	C	7	0402R	Resistor 5% 63mW	100R ~
R807	1620031	Bottom	I	2	0404_R_SR	RES NETWORK 0W06 2X1K0 J 0404	2x1k0 ~
R970	1430770	Bottom	I	7	0402R	Resistor 5% 63mW	4k7 ~
R971	1430770	Bottom	I	6	0402R	Resistor 5% 63mW	4k7 ~
R972	1430778	Bottom	J	7	0402R	Resistor 5% 63mW	10k ~
R973	1430784	Bottom	I	7	0402R	Resistor 5% 63mW	15k ~
R974	1430726	Bottom	I	6	0402R	Resistor 5% 63mW	100R ~
R975	1430726	Bottom	J	6	0402R	Resistor 5% 63mW	100R ~
S300	5209001	Bottom	D	1	BUTTON_EVQPUA02	SM SW TACT SPST 12V 50MA SIDE KEY	~ ~
S301	5209001	Bottom	G	1	BUTTON_EVQPUA02	SM SW TACT SPST 12V 50MA SIDE KEY	~ ~
S302	5409235	Bottom	A	6	SWITCH_SKRE_II	SM TACT SW TRAV 0.2 4.1X3.55X1.75	~ ~
T500	3640423	Bottom	L	3	TRANS_LDB15	BALUN TRANS 3.7GHZ+/-300MHZ 0805	~ ~
T700	4550223	Bottom	C	3	TRANS_LDB15	TRANSF BALUN 1800+-100mhz 2x1.25	~ ~
T701	4550165	Bottom	D	7	TRANS_LDB15	TRANSF BALUN 1.9GHZ+-100MHZ 2X1.25	~ ~
V100	4113721	Top	R	4	CASE_457	TVS DI 1PMT16AT3 16V 175W PWRMITE	~ ~
V300	4110475	Top	L	6	EMD2	SCH DI RB521S-30 200MA 35V SOD523	~ ~
V356	4110965	Bottom	O	7	SOD_523	CAP.DI BB202 CT=2.5 FM 0R8 SOD523	~ ~
V357	4110965	Bottom	O	7	SOD_523	CAP.DI BB202 CT=2.5 FM 0R8 SOD523	~ ~
V800	4219903	Bottom	I	2	SOT_363	TRX2 BFM505 N 20V 18MA 9GHZ SOT363	~ ~
V802	4210261	Bottom	C	7	SOT_363	TR BGA428 LNA1.8GHZ 19.5DB SOT363	~ ~
X100	5409141	Bottom	G	4	CONN_T_297449C	SM BATTERY CONN 4POL SPR. 12V 2A	~ ~
X101	5460061	Bottom	T	5	SYSCON_MQ202_NK_14R3_VJ	SM SYSTEM CONNECTOR 14POL	~ ~
X301	5469135	Top	L	2	CPBT_297884_6	SM CONN 2X8 SPR 50V 0.5A PCB/PCB	~ ~
X302	5469175	Top	B	6	CON_DF23C_10DS	SM CONN BTB 2X5 F P0.5	~ ~
X386	5400085	Bottom	P	3	SIM_READER_HD940	SIM CARD READER 2X3POL P2.54 SM	~ ~
X970	5409259	Bottom	F	7	CLE9014_01E	SM CONN 2X7F P1.4 CAMERA CIF-J	~ ~
Z300	4120031	Top	M	2	uBGA24	EMI/ESD FILT EMIF10-1K010F1 BGA24	~ ~
Z700	4511337	Bottom	E	2	DCC6D_H1.225	SAW FILT 897.5+-17.5MHZ/2.6DB 3X3	897.5MHz ~
Z800	4550249	Bottom	C	6	EZFL897SK60B	ANT.SW+2SAW 880-960/1710-1990 MHZ	~ ~
Z806	4511339	Bottom	B	7	DCS4D_H1.0	SAW FILT 1960+-30MHZ/2.7DB 2X2.5	1960MHz ~

[This page left intentionally blank.]